

www.cywee.com

Air
SHUTTLETM 愛秀
User Manual 使用手冊

CYWEE

歡迎並感謝您購買 Air Shuttle

Welcome. Thank you for
purchasing your
Air Shuttle.

目錄 Table of Contents

第1章: 開始使用 Air Shuttle

- 06 裝置說明
- 06 包裝內容
- 07 支援設備

第2章: 安裝使用 Air Shuttle

- 10 將裝置連接電視或液晶顯示器
- 12 使用方法

第3章: Air Shuttle 疑難解答

- 14 充電指南
- 14 清潔指南
- 15 技術規格
- 16 故障排除
- 17 安全規章
- 19 聯繫我們

Chapter 1: Getting Started With Air Shuttle

- 22 Introduction
- 22 Package Contents
- 22 Compatible Devices

Chapter 2: Connecting Your Air Shuttle

- 26 Set Up
- 28 Usage

Chapter 3: Troubleshooting Your Air Shuttle

- 30 Charging Instructions
- 30 Maintenance
- 31 Technical Specifications
- 32 Troubleshooting
- 33 Safety Information
- 35 Contact Us

1

開始使用 Air Shuttle

裝置說明

CyWee Air Shuttle™ 愛秀是一款不需連接傳輸線就可以將手機上的多媒體訊息無線傳輸到電視螢幕上的即插即用裝置。便於攜帶的特色使您可以從居家帶到室外，適用於各種娛樂活動，商業活動與其他各種應用場合。

包裝內容

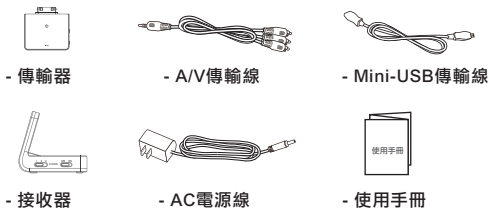

接收器 接口/按鈕

1. 頻道切換器
2. 電源開關
3. DC-IN 電源孔
4. A/V輸出接口

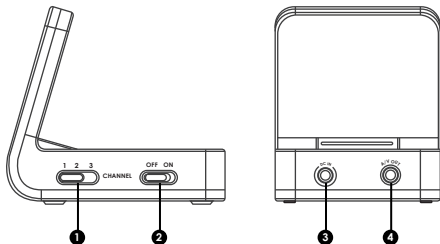

傳輸器 接口/按鈕

1. 頻道切換器
2. 電源開關
3. Mini-USB接口

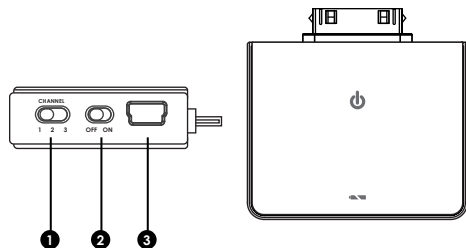

支援設備

1. iPhone 4®
2. iPhone 3GS
3. iPhone 3G
4. iPhone
5. iPad™
6. iPod touch® (第四代)
7. iPod touch (第三代)
8. iPod touch (第二代)
9. iPod nano (第六代)
10. iPod nano (第五代和第四代)

2

安裝使用 Air Shuttle

將裝置連接電視或液晶顯示器

1. 將AC充電器連接主接收器的DC-IN電源孔。
2. 確認已將傳輸器和接收器設定到相同的頻道。
3. 將已充電完成的傳輸器連接至手機，並打開傳輸器電源。

4. 將A/V傳輸線（紅，黃，白接頭）插入電視上的A/V輸入接口，並將A/V傳輸線的另一端插入接收器的A/V輸出接口。
5. 將電視設定為A/V輸入。
6. 享受即時傳輸到電視螢幕上的無線娛樂內容。

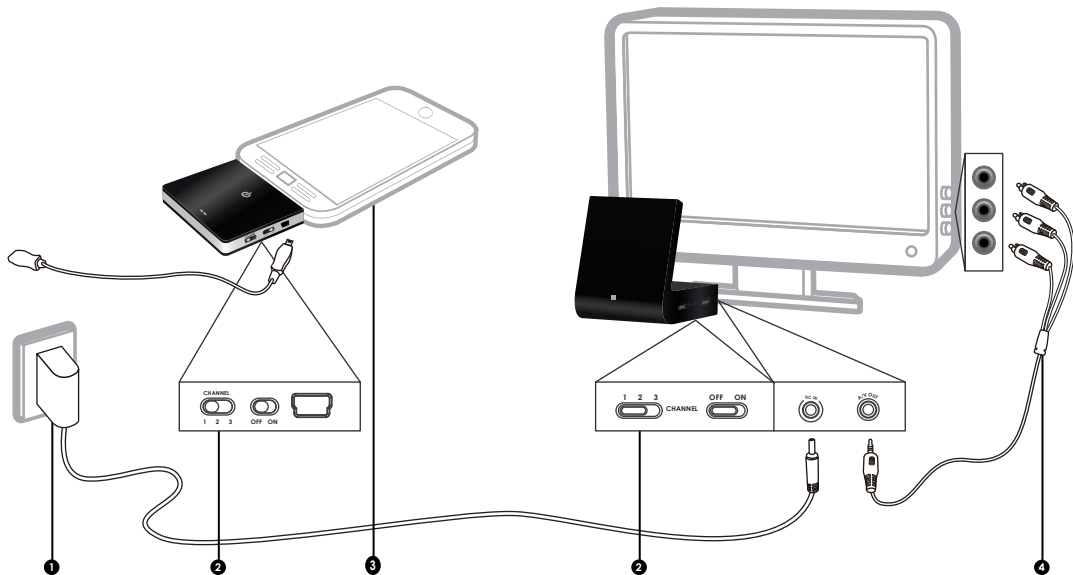

3

如何播放一部影片

1. 確認傳輸器為滿電狀態(電源開啟時為綠色燈號)並且接收器已連接輸出設備。
2. 對於iPhone用戶，請點選主螢幕上的"iPod"，然後從清單中選擇欲播放的影片。
3. 對於iPad和iPod touch用戶，請點選主螢幕上的"視訊"，進入後，點擊"播放"。
4. 該影片將會立刻在電視螢幕上播放。

如何以幻燈片模式欣賞照片

1. 在螢幕上點選"照片"(照片經由TV-out功能播放，須使用幻燈片播放模式)。
2. 點選相簿列表中欲播放的相簿。
3. 進入相簿後，點選欲欣賞的照片，對於iPhone或iPod touch用戶，請點擊下方的幻燈片播放按鍵。
4. 進入相簿後，點選欲欣賞的照片，對於iPad用戶，請點擊右上方的幻燈片播放按鍵。
5. 點擊後，照片將會立刻傳輸到電視螢幕上。

如何開始一個應用程式

1. 下載一個支援iPhone、iPad、iPod touch的TV-out功能應用程式。
2. 從主螢幕點選該程式。
3. 大多數支援TV-out功能的應用程式會立刻在電視螢幕上顯示。
4. 對於一些應用程式，如遊戲，可能需要一些額外的步驟，請參閱螢幕上顯示的訊息指南。

如何開始一個檔案文件

1. 從App Store下載一個支援TV-out功能的檔案文件程式(如iPad上的Keynote或GoodReader)。
2. 從主螢幕上點選該程式。
3. 對於一些檔案文件程式，須確認已連接網路，然後依照程式步驟說明，將檔案文件傳輸至手機上。
4. 完成檔案文件傳輸後，進入欲播放的檔案文件，點擊播放，則該檔案文件將會立刻在電視螢幕上顯示。

Air Shuttle 疑難解答

充電指南

傳輸器充電

1. 當傳輸器的電池LED燈開始閃爍紅光時，即表示傳輸器進入低電力狀態，此時請進行充電 (傳輸器約在10分鐘後停止傳輸多媒體訊息至電視)。
2. 將Mini-USB傳輸線連接到傳輸器上。
3. 將另一端USB接頭連接到一個支援USB的電源上 (電腦、USB充電器等)。
4. 當傳輸器充電時，電池LED燈將會持續顯示紅光。
5. 當傳輸器完全充滿電時，電池LED燈將會關閉。

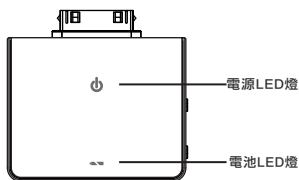

清潔指南

1. 移除電源與所有連接在傳輸器與接收器上的設備及電線。
2. 使用清潔劑前，請先使用一張濕潤的絨布，輕輕擦除表面上的汙漬。去除表面汙漬後，使用一塊乾燥的絨布擦乾該裝置。
3. 清潔時，請勿使用任何含有酒精或易燃液體的清潔劑擦拭。

技術規格

傳輸器 (TX)

尺寸	44mm (長) x 53mm (寬) x 15mm (高)
重量	30.76 公克
I/O 連接器/指示器	iPhone® 30-pin接頭、Mini-USB 接孔 x 1 (支援充電)、電源開關 x 1、LED燈 x 2、 頻道切換器 x 1 (支援3個頻道)
影片格式	NTSC / PAL
電源與電池	可充電電池：335mAh 最長可撥放時間：約2小時
工作頻段	5.8GHz (FM)
工作溫度	0-50° C，0-122° F

接收器 (Rx)

尺寸	82mm (長) x 60mm (寬) x 73mm (高)
重量	80.2 公克
I/O 連接器/指示器	LED燈 x 1、DC-IN 電源孔 x 1、A/V 輸出 接口 x 1
影片格式	NTSC / PAL
電源	電力消耗：210mA/6V
AC電源線	+6V，Ⓛ，3W
工作頻段	5.8GHz (FM)

故障排除

1. 傳輸器無法啟動

請確認傳輸器已完成充電並已將接收器調到正確設定（如電線插接、頻道調整、電源開啟）。若傳輸器電量不足，請使用Mini-USB傳輸線對傳輸器進行充電。

2. 圖片/影片解析度不清楚

此問題可能是另一個用戶與您的距離過近或選擇相同頻道所造成的。您可以嘗試調整傳輸器與接收器的距離或選擇另一個能提供最清晰圖片/影片解析度的頻道來解決這個問題。

3. 圖片/影片無法在電視螢幕上顯示

確認已將電視切換至AV訊號輸入模式，同時，須確認所使用的應用程式是能夠支援iPhone、iPad、iPod touch的TV-out功能。

4. 螢幕上出現"此配件尚未針對iPhone進行優化處理"

為了確保傳輸器接口的使用壽命及避免因不當插拔而造成的錯誤訊息，請先檢查接口處是否有灰塵髒汙，清潔後再將傳輸器"平行"插入手機，以避免此情況發生。

服務與支援

從下表取得服務訊息

取得訊息	方式
服務與支援討論，使用教學和下載	前往 www.cywee.com
支援 TV-out功能的應用程式	前往 www.cywee.com

燈號狀態說明

當傳輸器 (TX)	燈號狀態
電源開啟	綠燈亮
電源關閉	無任何燈號
低電量 (電源開啟)	紅燈閃爍/綠燈亮
充電狀態 (電源開啟)	紅燈亮/綠燈亮
充電狀態 (電源關閉)	紅燈亮
蓄電已滿	無任何燈號
當接收器 (RX)	燈號狀態
開啟	綠燈亮
關閉	無任何燈號

保固卡、警告、維修

請將保固卡，相關文件與裝置一起存放。若將裝置交給第三方維修，應同時將所有的保固文件交給對方。

維修

僅限持有技術認證的維修人員可以對此裝置進行維修。未經授權的拆卸和不正確的維修方式皆可能造成裝置的損害。

運輸

使用原裝包裝或其他適合的包裝。包裝必須能在運送過程中保護裝置不因顛簸、擠壓、潮濕和靜電而損壞。

警告

不要將接頭強行接入接口。如果接頭與接口不能輕易的連接，這表示它們可能不是配對的。確認接頭與接口是正確的配對及在連接時插入相對應的接口。

FCC Compliance Statement

This device complies with Part 15 of the FCC Rules. Operation is subject to the following two conditions: (1) this device may not cause harmful interference, and (2) this device must accept any interference received, including interference that may cause undesired operation.

FCC Part 2 / ICRSS102 Notice

IMPORTANT NOTE:

FCC Radiation Exposure Statement:

This equipment complies with FCC radiation exposure limits set forth for an uncontrolled environment. This equipment should be installed and operated with minimum distance 1.5cm between the radiator & your body.

FCC Interference Statement

This equipment has been tested and found to comply with the limits for a Class B digital device, pursuant to Part 15 of the FCC Rules. These limits are designed to provide reasonable protection against harmful interference in a residential installation. This equipment generates, uses and can radiate radio frequency energy and, if not installed and used in accordance with the instructions, may cause harmful interference to radio communications. However, there is no guarantee that interference will not occur in a particular installation. If this equipment does cause harmful interference to radio or television reception, which can be determined by turning the equipment off and on, the user is encouraged to try to correct the interference by one or more of the following measures:

- Reorient or relocate the receiving antenna.
- Increase the separation between the equipment and receiver.
- Connect the equipment into an outlet on a circuit different from that to which the receiver is connected.
- Consult the dealer or an experienced radio/TV technician for help.

FCC Caution: Any changes or modifications not expressly approved by the party responsible for compliance could void the user's authority to operate this equipment.

This device complies with Part 15 of the FCC Rules. Operation is subject to the following two conditions: (1) This device may not cause harmful interference, and (2) this device must accept any interference received, including interference that may cause undesired operation. This device and its antenna(s) must not be co-located or operating in conjunction with any other antenna or transmitter. This Class [B] digital apparatus complies with Canadian ICES-003.
Cet appareil numérique de la classe [B] est conforme à la norme NMB-003 du Canada.

聯絡我們

請聯絡您所購買的零售商或上www.cywee.com尋求協助

iPhone, iPad, iPod classic, iPod nano, iPod shuffle, and iPod touch are trademarks of Apple Inc., registered in the U.S. and other countries. iPad is a trademark of Apple Inc.

"Made for iPod," "Made for iPhone," and "Made for iPad" mean that an electronic accessory has been designed to connect specifically to iPod, iPhone, or iPad, respectively, and has been certified by the developer to meet Apple performance standards. Apple is not responsible for the operation of this device or its compliance with safety and regulatory standards. Please note that the use of this accessory with iPod, iPhone, or iPad may affect wireless performance.

使用手冊中提及之其它公司和產品名稱均為其個別公司之商標。若使用手冊中提其第三方產品則僅供參考，並不構成認可或推薦。

CyWee及CyWee商標為速位互動股份有限公司註冊商標。

Copyright © 2011 CyWee Group Limited. All rights reserved.

1

Getting Started With Air Shuttle

Introduction

CyWee Air Shuttle™ is a plug-and-play device that enables users to stream media content from their Apple devices to a TV without the need for cables and wires. Extremely portable, the Air Shuttle can be transported from the home to the road for entertainment, business, and many other applications.

Package Contents



- Transmitter



- Mini-USB to USB Charging



- Receiver



- Receiver Power Adapter Cable



- User Manual



- Audio/Video Cable

Compatible Devices

1. iPhone 4®
2. iPhone 3GS
3. iPhone 3G
4. iPhone
5. iPad™
6. iPod touch® (4th Gen)
7. iPod touch (3rd Gen)
8. iPod touch (2nd Gen)
9. iPod nano (6th Gen)
10. iPod nano (5th and 4th Gen)

Receiver Connectors/Switches

1. Channel Selector
2. Power Switch
3. DC-IN Power Port
4. A/V OUT

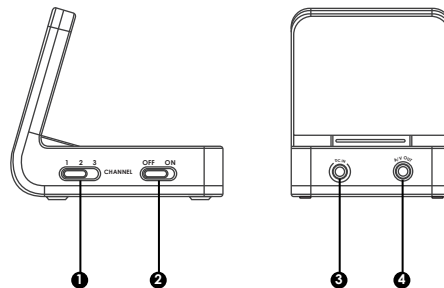

Transmitter Connectors/Switches

1. Channel Selector
2. Power Switch
3. Mini-USB Port

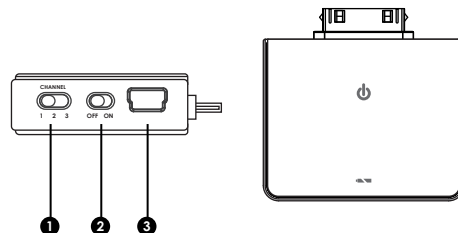

2

Connecting Your Air Shuttle

Set Up

1. Plug the Receiver Power Adapter Cable into the receiver's DC-IN power port and turn on the receiver.
2. Set the transmitter and receiver channel switches to the same channel.
3. Attach the fully charged transmitter into the mobile device and turn on. When the transmitter is on, the Power LED emits a green light.
4. Plug the Audio/Video cable (red, yellow, and white connectors) into the audio/video input ports on your TV. Attach the opposite end of the cable into the receiver's A/V OUT port.
5. On your TV, select the appropriate input setting.
6. You are now ready to begin streaming media wirelessly to your TV.

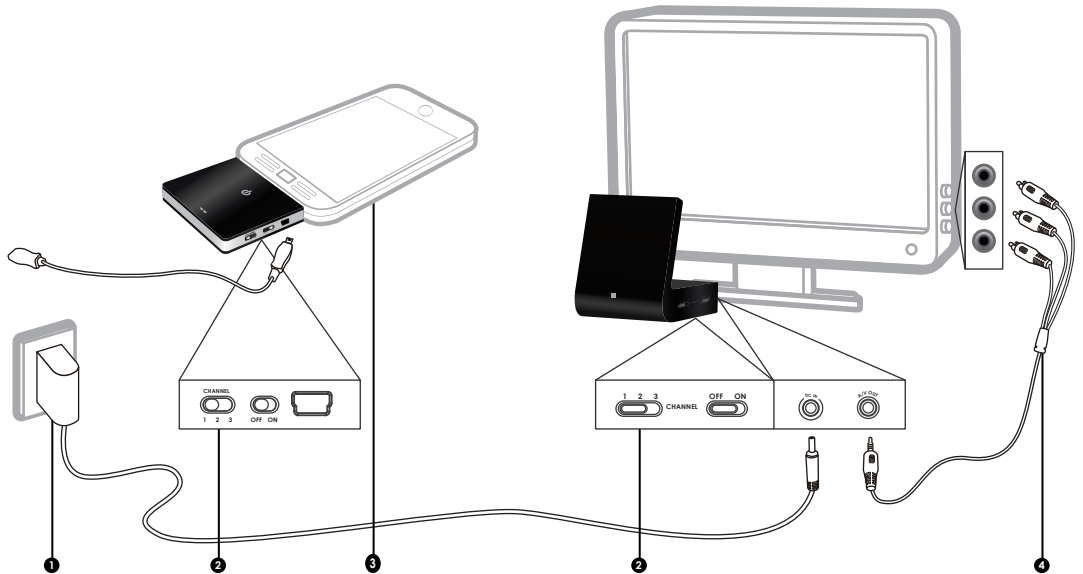

3

Troubleshooting Your Air Shuttle

Streaming a video/movie

1. Make sure the transmitter is fully charged, and both devices are set up for streaming. (see Set Up)
2. For iPhone users, select the "iPod" icon and then play a video from your library.
3. For iPad and iPod touch users, select the "Videos" icon and press "play" to begin streaming.
4. The video will show be played on your TV screen.

Streaming a photo slideshow

1. Select the "Photos" icon.
2. Photos using the TV-out can only be shown as a slideshow.
3. On an iPad, select "slideshow" and "start" to begin viewing photos.
4. On an iPhone or iPod touch, press "play" to start slideshow and begin viewing. The slideshow will instantly appear on the TV.

Streaming an app

1. Download and install an app that supports Apps TV-out function. For a list of apps that support Apple's TV-out function, please visit www.cywee.com.
2. Launch the app from your device.
3. Most apps that support TV-out will automatically appear on the TV screen.
4. For some apps such as games, additional steps may be required. Follow the onscreen instructions to display on the TV.

Streaming a presentation

1. You must have a presentation app installed on your device that supports TV-out to use this function. (e.g., Keynote for iPad)
2. Launch the presentation app.
3. For some presentation apps, the presentation can only be viewed in slideshow mode.
4. Start the slideshow and the presentation will be instantly displayed on the TV screen.

Charging Instructions

Charging the Transmitter

1. When the red LED flashes, the device has less than ten minutes of playback time and will need to be charged immediately.
2. Connect the mini-USB cable to the transmitter.
3. Connect the USB cable to a power source that accepts USB. (computer, USB charger, etc.)
4. When charging, the Battery LED will emit a red light.
5. When the transmitter is fully charged, the Battery LED will turn off.

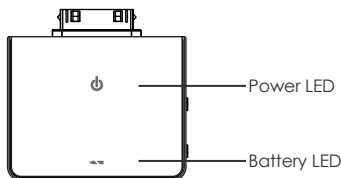

Maintenance

1. Unplug the power and disconnect all external devices and cables from the transmitter and receiver.
2. Gently remove any surface dirt using a damp, soft lint-free cloth. Dry the plastic with a soft lint-free cloth after cleaning.
3. To clean the device, do not use cleaning sprays or solvents of any kind containing alcohol or other inflammable liquids.

Technical Specifications

Transmitter End	
Dimensions	1.7 in(L) x 2 in(W) x 0.6 in(H) 44 mm(L) x 53 mm(W) x 15 mm(H)
Weight	30.76(g) / 1.09(oz)
Connectors	Apple 30-pin dock connector, mini-USB port
Switches	Power On/Off Switch, Channel Selector with 3 channels
Indicators	2 LED Indicators
Video Format	NTSC / PAL
Power & Battery	335mAh Lithium Ion Battery Playback time: 2hr+
Operating Frequency	5.8GHz (FM)
Operating Temperature	0-50° C, 0-122° F

Receiver End	
Dimensions	3 in(L) x 2 in(W) x 3 in(H) 82 mm(L) x 60 mm(W) x 73 mm(H)
Weight	80.2(g) / 2.83(oz)
Connectors	DC-IN, A/V OUT
Switches	Power On / Off Switch, Channel Selector with 3 channels
Video Format	NTSC / PAL
Power	Power consumption: 230mA / 6V
AC Adapter	+6.0V, ϕ , 3W
Operating Frequency	5.8GHz (FM)

Troubleshooting

1. I can't get the transmitter to turn on.

Make sure that your transmitter is fully charged, and that the receiver is set up properly. In the event that the transmitter battery is not charged, power the transmitter with the included mini-USB to USB cable.

2. My picture quality is not clear.

It is possible that there is another user in close proximity. You can solve this by changing the transmitter and receiver to a different channel. Choose the channels that provide the clearest picture and sound quality. Both transmitter and receiver must have the same channel selected.

3. I can't get the picture to display on the TV.

Check to make sure you have switched your TV input to the appropriate selection that corresponds to the plugged in Audio/Video cable. Additionally, make sure the application you are running is enabled for iPhone/iPad/iPod TV-out functionality.

4. "This accessory is not optimized for this iPhone" or "This accessory is not supported by iPhone" appears when I attach transmitter into my iPhone.

This message may appear as an indicator that your iPhone's pin connectors may be loose or dirty from frequent use. If your device's pin connectors are dirty, 1) always use an approved cleaning device/cloth and remove excess lint or dirt that may have accumulated; 2) reboot/restart your iPhone/iPad/iPod. If your Apple device has loose pin connectors, 1) reboot/restart your iPhone/iPad/iPod; 2) attach the transmitter to the iPhone in a straight line (180°) to minimize this occurrence.

Service and Support

The following table describes where to get service information.

To learn about	Do This
Service and support discussions, tutorials, and downloads	Go to www.cywee.com
What apps support Apple's TV-out function	Go to www.cywee.com

LED Indicators

If Tx is	The status LED is
On	Green status LED is on
Off	Off
Low battery – (power on)	Red status LED is flashing / Green status LED is on
Charging – (power on)	Red status LED is on / Green status LED is on
Charging – (power off)	Red status LED is on
Fully charged	Off
If Rx is	The status LED is
On	Green status LED is on
Off	Off

Safety Information / Warnings / Warranty Repair

Keep safety notes and other documentation together with device.

Repair

Only qualified technicians should repair the device. Unauthorized opening and improper repair can result in considerable danger to the user, the device, and may also void the warranty. Please refer to www.cywee.com for detailed information regarding warranty.

Warning

Never force a connector into a port. If the connector and port do not join with ease, they probably do not match. Ensure that the connector matches the port and that you have positioned the connector correctly in relation to the port.

FCC Compliance Statement

This device complies with Part 15 of the FCC Rules. Operation is subject to the following two conditions: (1) this device may not cause harmful interference, and (2) this device must accept any interference received, including interference that may cause undesired operation.

FCC Part 2 / ICRSS102 Notice

IMPORTANT NOTE:

FCC Radiation Exposure Statement:
This equipment complies with FCC radiation exposure limits set forth for an uncontrolled environment. This equipment should be installed and operated with minimum distance 1.5cm between the radiator & your body.

FCC Interference Statement

This equipment has been tested and found to comply with the limits for a Class B digital device, pursuant to Part 15 of the FCC Rules. These limits are designed to provide reasonable protection against harmful interference in a residential installation. This equipment generates, uses and can radiate radio frequency energy and, if not installed and used in accordance with the instructions, may cause harmful interference to radio communications. However, there is no guarantee that interference will not occur in a particular installation. If this equipment does cause harmful interference to radio or television reception, which can be determined by turning the equipment off and on, the user is encouraged to try to correct the interference by one or more of the following measures:

- . Reorient or relocate the receiving antenna.
- . Increase the separation between the equipment and receiver.
- . Connect the equipment into an outlet on a circuit different from that to which the receiver is connected.
- . Consult the dealer or an experienced radio/TV technician for help.

FCC Caution: Any changes or modifications not expressly approved by the party responsible for compliance could void the user's authority to operate this equipment.

This device complies with Part 15 of the FCC Rules. Operation is subject to the following two conditions: (1) This device may not cause harmful interference, and (2) This device must accept any interference received, including interference that may cause undesired operation.

This device and its antenna(s) must not be co-located or operating in conjunction with any other antenna or transmitter. This Class [B] digital apparatus complies with Canadian ICES-003.

Cet appareil numérique de la classe [B] est conforme à la norme NMB-003 du Canada.

Contact Us

Should you require additional support, please contact one of our regional offices or contact us at : www.cywee.com

iPhone, iPad, iPod classic, iPod nano, iPod shuffle, and iPod touch are trademarks of Apple Inc., registered in the U.S. and other countries. iPad is a trademark of Apple Inc.

"Made for iPod," "Made for iPhone," and "Made for iPad" mean that an electronic accessory has been designed to connect specifically to iPod, iPhone, or iPad, respectively, and has been certified by the developer to meet Apple performance standards. Apple is not responsible for the operation of this device or its compliance with safety and regulatory standards. Please note that the use of this accessory with iPod, iPhone, or iPad may affect wireless performance.

Other company and product names mentioned herein are trademarks of their respective companies. Mention of third-party products is for informational purposes only and constitutes neither an endorsement nor a recommendation.

CyWee and the CyWee logo are registered trademarks of CyWee Group Ltd.

Copyright © 2011 CyWee Group Limited. All rights reserved.